

## Floorplan

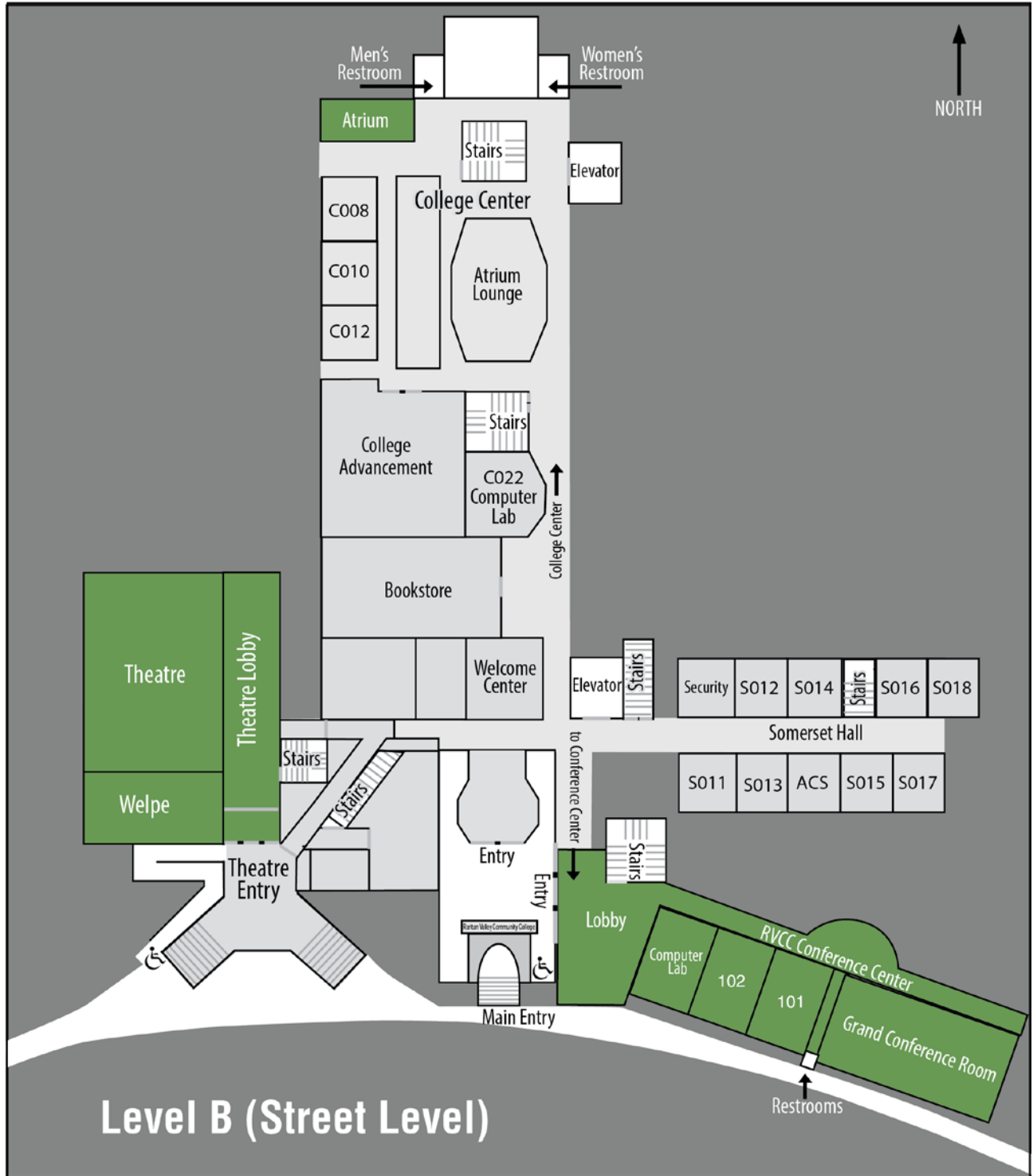

### Reservations or More Information

Contact Theatre and Conference Services at 908-526-1200 x8267 or [rentals@raritanval.edu](mailto:rentals@raritanval.edu)  
118 Lamington Road, Branchburg, NJ 08876 ■ [www.raritanval.edu](http://www.raritanval.edu)



## The Conference Center Rates

### MEETING ROOM

#### Capacity

Room	Square Footage	Rounds	Theatre	U-Shape	Boardroom	Classroom	Reception
Grand Conference Rooms A, B & C	3,696	250	420	-	-	249	450
Grand Conference Room A	1,232	80	140	-	-	72	150
Grand Conference Room B	1,232	80	140	-	-	72	150
Grand Conference Room C	1,232	80	140	-	-	72	150
ATCC Room 101	630	-	-	30	-	-	-
ATCC Room 102	630	-	-	30	-	-	-
ATCC Community Room	-	-	-	-	20	-	-
ATCC Computer Lab	-	-	-	-	-	24	-
ATCC Lobby	-	-	-	-	-	-	-
Atrium	-	80	80	-	-	-	120
Edward Nash Theatre	-	-	984	-	-	-	-
Welpel Theatre	-	-	200	-	-	-	-
Lower Theatre Lobby	-	-	-	-	-	-	-
Upper Theatre Lobby	-	-	-	-	-	-	-

#### Dimensions

Room	Room Dimensions
Grand Conference Rooms A, B & C	84' x 44'
Grand Conference Room A	28' x 44'
Grand Conference Room B	28' x 44'
Grand Conference Room C	28' x 44'
ATCC Room 101	21' x 30'
ATCC Room 102	21' x 30'
ATCC Community Room	-
ATCC Computer Lab	-
ATCC Lobby	-
Atrium	-
Edward Nash Theatre	-
Welpel Theatre	-
Lower Theatre Lobby	-
Upper Theatre Lobby	-

#### Reservations or More Information

Contact Theatre and Conference Services at 908-526-1200 x8267 or [rentals@raritanval.edu](mailto:rentals@raritanval.edu)  
118 Lamington Road, Branchburg, NJ 08876 ■ [www.raritanval.edu](http://www.raritanval.edu)